

SELECT PRODUCTS LIMITED

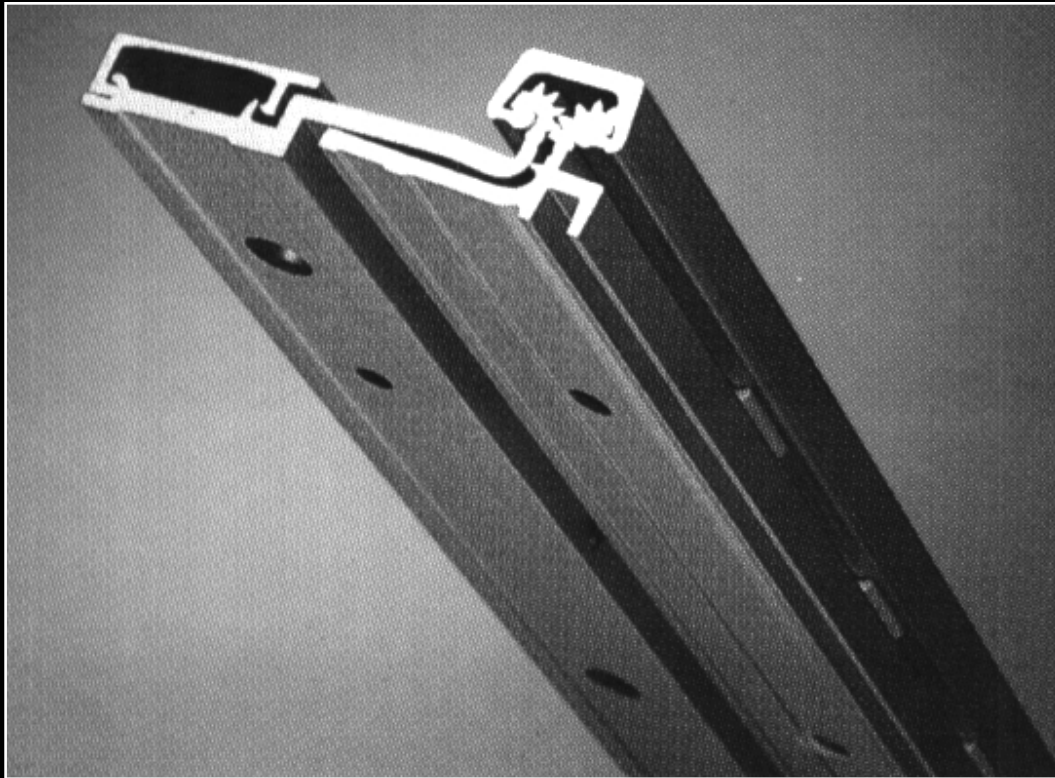

Page

- 2. Information on Select Continuous Hinges
- 3. SL-11, SL-11HD, SL-11LL Full Mortise Hinges
- 3. SL-24, SL-24HD, SL-24LL Full Mortise Hinges
- 4. SL-21, SL-21HD Full Surface Hinges
- 4. SL-27HD Full Surface Hinges
- 5. SL-57, SL-57HD Full Surface Hinges
- 5. SL-26HD Concealed Hinges
- 6. SL-53, SL-53HD Half Surface Hinges
- 6. SL-54, SL-54HD Half Surface Hinges



Complete Door Hardware Solutions

Mid West 1-800-522-2940

FAX 1-800-782-1160

JLM Wholesale 3095 Mullins Court Oxford, MI 48371

South East 1-800-768-6050

FAX 1-800-824-6051

JLM Wholesale SE 7517-A Orr Rd. Charlotte, NC 28213

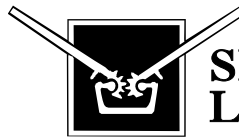

SELECT PRODUCTS CONTINUOUS HINGES

Select Products Limited of Kalamazoo, Michigan is a manufacturer of aluminum continuous-gear door hinges. The Select continuous gear hinge is a heavy-duty hinge system designed for commercial application with wood, aluminum and hollow metal doors and frames for storefront, office, school, hospital, and many other applications for both new construction and retrofit applications.

Benefits and advantages of an aluminum continuous gear hinge are many:

- Full length door height support.
- Streamlined, pleasing-to-the-eye appearance.
- No exposed screws, bolts, pins or knuckles.
- Anodized aluminum finish won't rust.
- Provides weather-proof, tamper-proof and noise reduction features.
- No cutouts or reinforcements in doors and frames required.
- Retrofit installation with existing doors and frames is easy and economical.
- Long entrance life - tested at over 1,000,000 cycles.

With conventional hinging systems, the top hinge or pivot handles close to 100% of the opening force of the door. With heavy usage, the top hinge or pivot can experience early, excessive wear, creating a failed entrance. A continuous gear hinge bonds the door and frame into an integrated, sag-free unit and "kick-back" energy is dissipated along the length of the door and frame. This improved engineering design has indisputable advantages over two and three hinge/pivot systems, and adds years of trouble-free, maintenance-free life to the entrance.

Features:

- Pinless assembly of 3 interlocking extrusions.
- Chemically lubricated bearings.
- Templated screw hole pattern.
- 410 stainless steel fasteners available in self-tapping or self-drilling.
- Standard and custom lengths available.
- Standard and custom finishes available.
- Standard and heavy duty available in all models.
- Lead-lined duty available in mortise models.
- All mortise hinges are fire-rated - call for details.
- Full and half surface available fire-rated, call for pricing.

Standard Finishes:

Clear Anodized - 204R1

Dark Bronze Anodized - .7 Mil

Custom Options:

Custom anodizing.

Painted colors can be matched on gear cap only or on the complete hinge.

Standard Lengths:

7'0" (83") - 7'2" (85") - 8'0" (95") - 10'0" (120")

Custom Lengths:

Available upon request with additional lead times. All Select hinges can be field cut to exactly fit doors, or cut in the factory to specified lengths. Any custom length hinge that requires the removal of 5" or more will have an additional fee.

Mid West 1-800-522-2940
FAX 1-800-782-1160

JLM Wholesale 3095 Mullins Court Oxford, MI 48371



South East 1-800-768-6050
FAX 1-800-824-6051

JLM Wholesale SE 7517-A Orr Rd. Charlotte, NC 28213



SL-11 FULL MORTISE HINGES

SL-11 Series

Full mortise hinge for use in new construction, and in renovations requiring door. Mounts flush with no door inset.

Weight: Approx. 6 lbs.

Models:

SL-11 Standard duty for medium frequency doors weighing up to 200 lbs.

SL-11HD Heavy duty for high frequency or heavy medium frequency doors weighing up to 450 lbs.

SL-11LL For lead-lined doors and extra heavy-duty applications up to 1,000 lbs.

Fasteners:

12-24 x 1/2" 410 stainless steel, flathead Phillips, undercut, self-tapping fasteners are provided as standard pack. 12-24 x 3/4" 410 stainless steel, flathead Phillips, undercut, self-drilling tek screws available upon request. Wood and security screws also available.

To Order Specify:

- 1) Model Number
- 2) Size - 83", 85", 95" or 120"
- 3) Finish

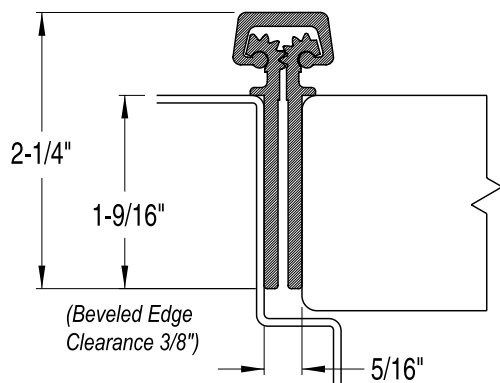

SL-24 FULL MORTISE HINGES

SL-24 Series

Full mortise hinge for use in new construction, and in renovations requiring door and/or frame replacement. Mounts with 1/16" door inset.

Weight: Approx. 6 lbs.

Models:

SL-24 Standard duty for medium frequency doors weighing up to 200 lbs.

SL-24HD Heavy duty for high frequency or heavy medium frequency doors weighing up to 450 lbs.

SL-21LL For lead-lined doors and extra heavy-duty applications up to 1,000 lbs.

Fasteners:

12-24 x 1/2" 410 stainless steel, flathead Phillips, undercut, self-tapping fasteners are provided as standard pack. 12-24 x 3/4" 410 stainless steel, flathead Phillips, undercut, self-drilling tek screws available upon request. Wood and security screws also available.

To Order Specify:

- 1) Model Number
- 2) Size - 83", 85", 95" or 120"
- 3) Finish

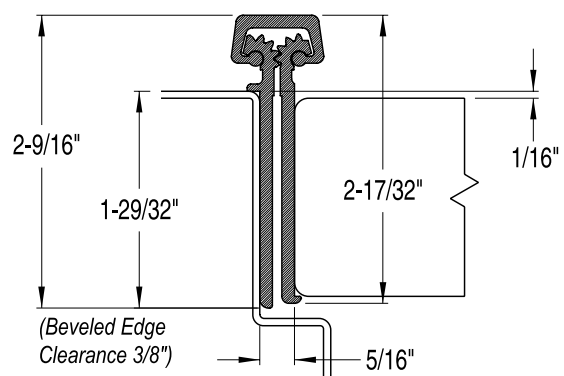

Mid West 1-800-522-2940
FAX 1-800-782-1160

JLM Wholesale 3095 Mullins Court Oxford, MI 48371



South East 1-800-768-6050
FAX 1-800-824-6051

JLM Wholesale SE 7517-A Orr Rd. Charlotte, NC 28213

CONTINUOUS HINGES

SL-21 & SL27HD Full Surface

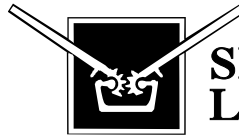

**SELECT PRODUCTS
LIMITED**

SL-21 FULL SURFACE HINGES

SL-21 Series

Full surface hinge for replacement for heavy duty entrances using existing door and frame, or for new or existing entrances where the door must swing completely out of the frame opening.

Weight: Approx. 8 lbs.

Models:

SL-21 Standard duty for medium frequency doors weighing up to 200 lbs.

SL-21HD Heavy duty for high frequency or heavy medium frequency doors weighing up to 450 lbs.

Fasteners:

12-24 x 1/2" 410 stainless steel, flathead Phillips, undercut, self-tapping fasteners are provided as standard pack, together with 1-1/2" sex bolts and 1/4-20 shoulder screws for surface mount on the door. Option of 12-24 x 3/4" self drilling tek screws available for the frame leaf. Wood and security screws also available.

To Order Specify:

- 1) Model Number
- 2) Size - 83", 85", 95" or 120"
- 3) Finish

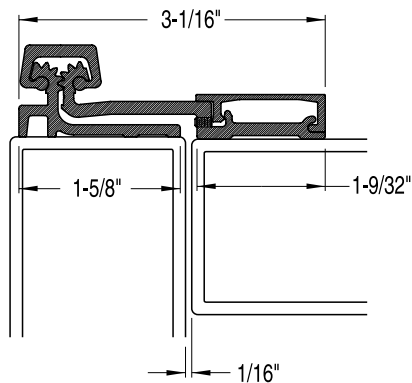

SL-27HD FULL SURFACE HINGES

SL-27HD Series

Concealed continuous hinge for 2" thick heavy doors in heavy traffic entrances. Mounts flush.

Weight: Approx. 6 lbs.

Model:

SL-27HD Heavy duty for high frequency or heavy frequency doors weighing up to 1000 lbs.

Fasteners:

12-24 x 1/2" 410 stainless steel, flathead Phillips, undercut, self-tapping fasteners are provided as standard pack. 12-24 x 3/4" 410 stainless steel, flathead Phillips, undercut, self-drilling tek screws available upon request. Wood and security screws also available.

To Order Specify:

- 1) Model Number
- 2) Size - 83", 85", 95" or 120"
- 3) Finish

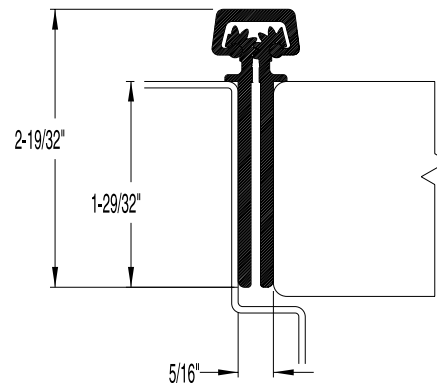

Mid West 1-800-522-2940
FAX 1-800-782-1160

JLM Wholesale 3095 Mullins Court Oxford, MI 48371



South East 1-800-768-6050
FAX 1-800-824-6051

JLM Wholesale SE 7517-A Orr Rd. Charlotte, NC 28213



SL-57 FULL SURFACE HINGES

SL-57 / SL-57HD

Full surface hinge for replacement for heavy duty entrances using existing door and frame. For installation with narrow or inset frames with minimum 7/8" face width. Mounts with 1/16" door inset.

Weight: Approx. 8 lbs.

Models Available:

SL-57 Standard duty for medium frequency doors weighing up to 200 lbs.

SL-57HD Heavy duty for high frequency or heavy medium frequency doors weighing up to 450 lbs.

Fasteners:

12-24 x 1/2" 410 stainless steel, flathead Phillips, undercut, self-tapping fasteners are provided as standard pack, together with 1-1/2" sex bolts and 1/4-20 shoulder screws for surface mount on the door. Option of 12-24 x 3/4" self drilling tek screws available for the frame leaf. Wood and security screws also available.

To Order Specify:

- 1) Model Number
- 2) Size - 83", 85", 95" or 120"
- 3) Finish

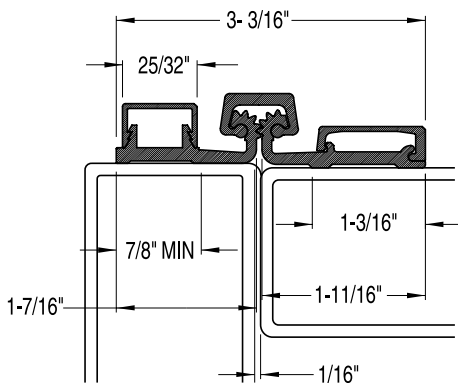

SL-26HD CONCEALED HINGES

SL-26HD

Concealed continuous hinge for 2" thick heavy doors in heavy traffic entrances. Mounts with 3/32" door inset.

Weight: Approx. 6 lbs.

Models Available:

SL-26HD Heavy duty for high frequency or heavy frequency doors weighing up to 1000 lbs.

Fasteners:

12-24 x 1/2" 410 stainless steel, flathead Phillips, undercut, self-tapping fasteners are provided as standard pack. 12-24 x 3/4" 410 stainless steel, flathead Phillips, undercut, self-drilling tek screws available upon request. Wood and security screws also available.

To Order Specify:

- 1) Model Number
- 2) Size - 83", 85", 95" or 120"
- 3) Finish

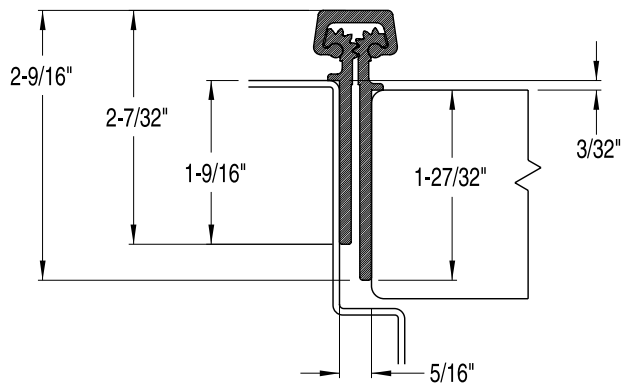

CONTINUOUS HINGES

SL-53 & SL54HD Half Surface

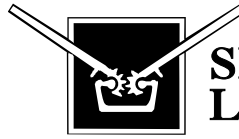

**SELECT PRODUCTS
LIMITED**

SL-53HD HALF SURFACE HINGES

SL-53HD

Half surface hinge for permanent replacement for heavy duty entrances using existing frame and new door. Mounts with 3/32" door inset.

Weight: Approx. 7 lbs.

Models Available:

SL-53HD Heavy duty for high frequency or heavy medium frequency doors weighing up to 450 lbs.

Fasteners:

12-24 x 1/2" 410 stainless steel, flathead Phillips, undercut, self-tapping fasteners are provided as standard pack, together with 1-1/2" sex bolts and 1/4-20 shoulder screws for surface mount on the door. Option of 12-24 x 3/4" self drilling tek screws available for the frame leaf. Wood and security screws also available.

To Order Specify:

- 1) Model Number
- 2) Size - 83", 85", 95" or 120"
- 3) Finish

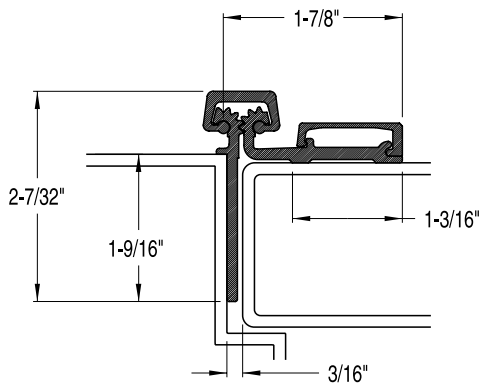

SL-54HD HALF SURFACE HINGES

SL-54HD

Half surface hinge for replacement for heavy duty entrances using existing frame and new door. Mounts with 3/32" door inset. Frame leaf covers butt hinge cutouts.

Weight: Approx. 7 lbs.

Models Available:

SL-54HD Heavy duty for high frequency or heavy medium frequency doors weighing up to 450 lbs.

Fasteners:

12-24 x 1/2" 410 stainless steel, flathead Phillips, undercut, self-tapping fasteners are provided as standard pack, together with 1-1/2" sex bolts and 1/4-20 shoulder screws for surface mount on the door. Option of 12-24 x 3/4" self drilling tek screws available for the frame leaf. Wood and security screws also available.

To Order Specify:

- 1) Model Number
- 2) Size - 83", 85", 95" or 120"
- 3) Finish

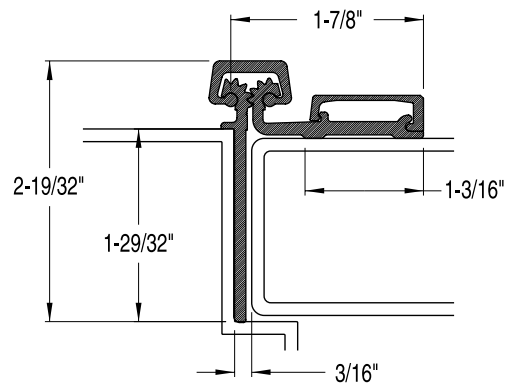

Mid West 1-800-522-2940
FAX 1-800-782-1160

JLM Wholesale 3095 Mullins Court Oxford, MI 48371



South East 1-800-768-6050
FAX 1-800-824-6051

JLM Wholesale SE 7517-A Orr Rd. Charlotte, NC 28213